



Kenilworth Playground Public Art Project: **Request for Qualifications**

The City of Petaluma ("City") is seeking qualified applicants to collaborate with park builders for the design of a public artwork-playground structure at Kenilworth Park. This Request for Qualifications (RFQ) document outlines the project goals and selection criteria for qualified designers, artists, firms, and creative teams ("Artist") to apply for the opportunity to work with the City's contracted Park Designer to design the public art-playground structure, which encompasses the play structure(s), play space(s), and public art elements for Kenilworth Park. This opportunity invites qualified applicants to apply for a \$30,000 awarded contract using the City's Public Art Fund for creative services to design a public artwork-playground structure proposal for Kenilworth Park in close collaboration with the City's Park Designer, represent the Public Art Program's goals and interests in the Kenilworth Revitalization project, and work with various City staff personnel and departments, City Commissions and Committees, and members of the general public throughout the entirety of the contract.

The deadline to submit applications to this opportunity is **Friday, June 9th, 2023 by 11:59PM**.

To apply for this opportunity, please visit the City of Petaluma Public Art Program's SlideRoom site at <https://petalumapublicart.slideroom.com/#/permalink/program/72201> to apply online.

NOTE: only digitally submitted applications using the SlideRoom site will be accepted and considered for this opportunity. For more information or questions about this application process, please visit <https://cityofpetaluma.org/kenilworth-playground-public-art/> or contact City of Petaluma Public Art Specialist David Ward at dward@cityofpetaluma.org.

Overview and Background

Kenilworth Park, which is owned and operated by the City, is located at 150 Fairgrounds Drive, Petaluma, California near the intersection of Payran Street and East Washington Street. The park is being reimagined and redesigned as a capital improvement project using Measure M and Proposition 68 funding managed by the City of Petaluma's Public Works and Parks and Recreation departments. This project is referred to as the Kenilworth Revitalization project ("Park Project").

To support the scope and impact of the Park Project, the City of Petaluma Public Art Committee (PPAC) has agreed to invest in the design and installation of a play structure as an integrated

component of the Park Project, which is referred to as the Kenilworth Park Playground Public Art Project (“Playground Project”). The Playground Project has been developed and sponsored by the PPAC which, as a parallel and integrated project, would support the overall Park Project design and vision as proposed by the Park Designer. The Playground Project is primarily managed by the PPAC and Planning staff in close collaboration with Parks and Recreation staff, Public Works staff, the Recreation, Music, and Parks Commission (RMPC), and the selected Park Designer. The contracted individual or team for the Playground Project will work as a close collaborator with the Park Designer to integrate the Playground Project into the Park Project seamlessly as an extension of the Park Project. To learn more about the Park Project Request for Proposals and the project scope for the Park Designer, please visit <https://cityofpetaluma.org/documents/rfp-for-kenilworth-park-revitalization-project/>.

The remainder of this document details the opportunity for application submissions for the Playground Project RFQ.

Project Scope

The Playground Project is a \$30,000 contract award opportunity for qualified, creative individuals or teams to design a unique public art-playground structure that creates a play-safe structure or structures for the Park Project’s proposed plan at Kenilworth Park. The ideal Playground Project proposal will utilize a creative approach to designing public art and play spaces at Kenilworth Park, ultimately creating a welcoming, family-friendly, inclusive, and community-celebrated destination. In addition to producing a design proposal for the play spaces, artwork, and play structures at Kenilworth Park, the awarded contract requires continued participation and project management from the awarded designer, artist, firm, or creative team (“Artist”) for all project public hearings, meetings with City officials and staff, as well as other coordinated efforts throughout the duration of the Playground Project. The contract award requires the Artist to provide creative services for the Playground Project and Park Project as mentioned above which will be detailed further later in this document under *Role of the Contracted Artist*.

The Playground Project Artist contract is funded by the City of Petaluma’s Public Art Fund for the creative services and project management mentioned above using a Professional Services Agreement with the City of Petaluma. Outside of this award contract, the PPAC has additionally committed future funds from the Public Art Fund towards the installation and fabrication budget of the agreed-upon public art-playground structure elements that are proposed in the Artist’s final approved design proposal. The Artist will work with the Park Designer, PPAC, and City staff to create a proposal within an appropriate budget that reasonably incorporates all parties’ and stakeholders’ considerations. The final Park Project proposal and budget will require ultimate approval by the Petaluma City Council where in tandem the Playground Project’s final design will be reviewed for approval. At the time of Council’s review and final approval, the Playground

Project's installation and fabrication budget will be contributed to the Park Designer or a subcontractor to construct the approved proposal.

Role of the Contracted Artist

The City of Petaluma Public Art Program is commissioning a qualified designer, artist, firm, or creative team ("Artist") through this RFQ to design the Playground Project. The primary scope of work and responsibilities for the contracted Artist in this project are as follows:

- Thoroughly understand the Park Designer's proposed site plan for Kenilworth Park as part of the Park Project and serve as a creative arm for the Kenilworth Revitalization team with primary focus on public art-playground structure and any additional play spaces or features in the project site
- Review and understand the vision, goals, and aspirations for the Playground Project as commented by the public, the PPAC, and other stakeholders
- Work in close collaboration with the Park Designer to imagine public art, play spaces, and the vision of the Park Project and integration of the Playground Project within the Park Designer's proposed site plan
- Create a design proposal of the public art, play structures, and the play spaces for Kenilworth Park within the context of the Park Project, the Playground Project's goals, the conceptual project budget, and other feedback from the City and community regarding Kenilworth Park in the scope of the Park Project and Playground Project
- Continue to modify the design proposal as needed throughout the entirety of the project's duration until approved by the Petaluma City Council
- Project management of the Playground Project during the design phase and continued participation until the completion of the construction phase of the Park Project
- Participate in all Playground Project meetings, Park Project meetings as needed, public hearings, community meetings, subcommittee meetings, and other project-related meetings as needed throughout the project's duration

Artist's Design Proposal

The City of Petaluma Public Art Program is commissioning the awarded Artist through this RFQ for creative services supporting the creation of a design proposal for the public artwork-playground structure and any additional play spaces and/or features at Kenilworth Park. Using the \$30,000 contract award, the Artist will provide creative services as described above to create a design proposal. The awarded Artist shall use collected feedback from the project's community outreach, project stakeholders, boards and commissions, and staff to create a design proposal of the public art-playground as well as any and all public art and play features proposed for the Kenilworth site, which will be fabricated and installed by a contracted playground builder. The

Artist must work in close collaboration with the Park Designer to create a proposal that seamlessly integrates all proposed public art-playground structure and any additional play spaces as part of the Park Project's final design. All proposal features must comply with safety, ADA, Building, CEQA, easements, and other requirements set in the City's zoning ordinance and as described in the Petaluma City and California State Building Code in addition to any requirements or conditions set forth in the City permitting process.

The PPAC and City staff will work with awarded Artist to clarify project goals, vision, aspirations, and resources for the Playground Project in support of the design proposal. The Artist's design proposal must consider the project's available budget for installation, construction, and fabrication in addition to other restrictions and parameters to the proposal created by the Park Designer, including but not limited to site layout, project timeline, resources, environmental factors, accessibility, landscaping, hardscape, utilities, facilities, and easements.

At the benefit of the applicant, the PPAC has requested project inspiration works be included in this RFQ document. Applicants will find images of projects that inspired this opportunity later in this document in ***Appendix B – Inspirational Project Design Examples***.

Project Site

The project site is the Kenilworth Park along Payran Street and East Washington Street located at 150 Fairgrounds Drive in Petaluma, California. The existing playground area (which shall be replaced) is located on the south-central portion of Kenilworth Park. The footprint of the playground has yet to be determined and will be designated during the Park Project's design proposal, which the awarded Artist will help determine. The map below shows an overlay of the park's boundary in black, including the yellow polygon outlining the existing playground, where the Park Project proposals will reimagination the park space.

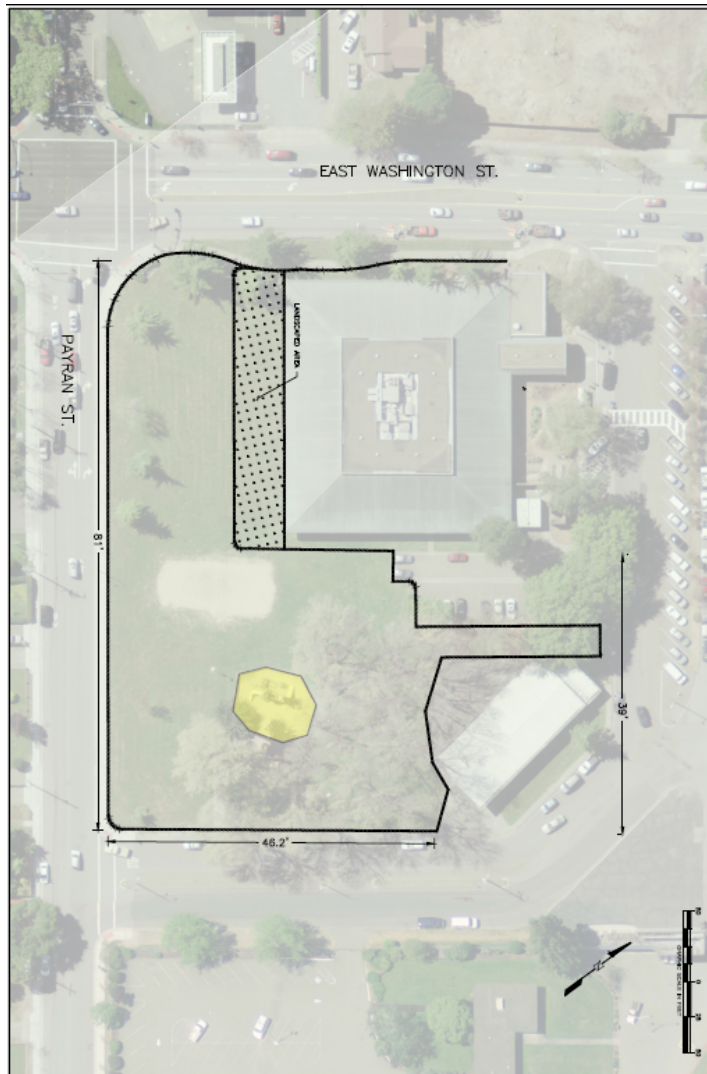

The Playground Project seeks to integrate a newly designed, site-specific, and unique public art-playground into the newly design park space seamlessly. The awarded Artist from this RFQ will work closely with the Park Project designer to create the public art-playground at the project site, including all public art features, play spaces, and play structures.

The existing park space is approximately 65,000 square feet in footprint. Adjacent to the park on this same parcel is the Petaluma Regional Library, which is the building on the north portion of the lot, in addition to the Kenilworth Teen Center, which is the building on the east portion of the lot. These structures are not part of the Playground or Park projects. Additionally, the existing parking lot between the Teen Center and Library is not part of either project.

Eligibility

The following criteria are required minimum qualifications that each applicant to this RFQ must have to be eligible for the Playground Project opportunity and contract for creative services with the City of Petaluma. These qualifications are minimum requirements that applicants must have before consideration of their experience and further desired qualifications for the Playground Project.

Applicants must be:

- At least 18 years or older to go into contract with the City, though teams may consult with individuals under 18 or include any aged individuals on their team for project input;
- A U.S. resident or citizen with a valid mailing address;

- A design, architecture, landscaping, or other creative professional with related experience (further details under *Selection Criteria* below);
- Work as part of a design team and as an intimate collaborator with the Park Designer;
- Available to meet with City staff to obtain additional information and input as needed as well as collaborate on an ongoing basis with the contract Park Designer;
- Available to attend recurring meetings, both remote and in-person, related to the project as needed throughout the project's entirety;
- Ability to produce conceptual site plans necessary for design services, including but not limited to landscape, civil, structural, and electrical design;
- Ability to understand and provide if necessary geotechnical, site plan, architectural, and other documents and reports;
- Provide engineering calculations for all proposed features included as part of the Artist's design proposal, including but not limited to necessary footings or foundations, fabricated play or artistic elements, and landscape or hardscape elements included in the design proposal;
- Have a thorough understanding of the California Building Code, "play safe" materials, playground safety features, and the Building permitting process.

The selected team or individual will be required to have the above qualities or be able to utilize subcontractors to provide the above services necessary to complete the described creative services in the Playground Project. Applicants are strongly encouraged to have a qualified professional playground designer/builder on their team or in their consultation. Professional architects and landscape architects are also eligible to apply.

To be considered for this opportunity and the contract award, applicants must also submit all materials listed in the *Application Requirements* below. Applicants are required to have read the entire RFQ document upon submitting their application.

Selection Criteria and Project Goals

The following section outlines the goals for the Playground Project that each applicant is required to respond to be considered for the contract award. Applicant responses shall showcase how their related experience and approach to this project can connect to these identified goals, demonstrating their qualification and related experience for this contract opportunity. The applicant's responses will be used by the PPAC to grade each applicant's qualifications for the Playground Project opportunity to be considered for the awarded contract services for this opportunity. Please note that to be considered for the design services contract award, applicants must meet the eligibility criteria listed above under *Eligibility*.

Project Goals

To clarify the vision of the Playground Project, applicants are required to review the following project goals listed under *Committee Goals* and *Community Goals*. Applicants will respond to these goals in their cover letter and by demonstrated experience in their image list, resume or CV, and references when applying for the contract award. The awarded applicant will be expected to champion these goals while creating, modifying, and finalizing their proposal for the Playground Project.

- **Committee Goals.** The PPAC has identified the following goals that the completed Playground Project will accomplish:
 - Uses public art to create a welcoming and memorable experience for children, teens, and families;
 - Welcomes and supports a deeper interaction with the surrounding neighborhood and businesses near Kenilworth Park;
 - Creates a visually stimulating environment for the newly designed Kenilworth Park site that is unique and inspires creativity, a sense of wonder, and play;
 - Engages with community aspirations for the future of Petaluma's neighborhoods (see *Community Goals* and *Appendix A – Community Engagement Survey Feedback* below for details);
 - Encourages cultural tourism with a new public art offering and play space by providing a centrally located, accessible family-friendly experience in Petaluma;
 - Partners with Parks and Recreation to expand the functional use, amenities, and aesthetic of an existing park and playground through incorporation of public art;
 - Provides and maintains an exuberantly creative, site-specific public art-playground structure(s) that is durable, safe, inclusive, and fun to interact with.
- **Community Goals.** The PPAC and Public Art Program have designed this opportunity to support a larger impact of the Park Project and offer a higher level of engagement in the community. Using a community survey, City staff asked members of the public to share their thoughts and feedback about goals, priorities, and aspirations for this project and for the Kenilworth Park site. The resulting data has been synthesized by the PPAC to create the *Project Goals* listed above. For more information about the survey, including the full data from the community engagement, please view ***Appendix A – Community Engagement Survey Feedback*** in this document.

Citywide Goals and Priorities

The following citywide goals and priorities will be addressed and/or supported by the project. Applicants to this RFQ do not need to respond to each of these goals, however the awarded Artist shall acknowledge how the proposed design for the Playground Project strives to meet these goals in the context of the list citywide goals.

- **Goal #116:** Maximize use of current parks and recreation infrastructure and other City-owned facilities and properties for hosting of recreational, sports, cultural and entertainment events that attract visitors to Petaluma
- **Goal #137:** Explore opportunities for more murals and art installations citywide
- **Goal #138:** Continue to maintain and update City facilities that provide places and spaces for community dialogue, public meetings, and customer service
- **Goal #149:** Develop a plan to prioritize playground upgrades/replacement and accessibility improvements.

Roles & Responsibilities

The following individuals, organizations, departments, and community groups are identified in this project as key stakeholders and collaborators. The contracted Artist should anticipate working with following personnel and bodies during the Playground Project; each has been summarized for their role within the project.

- Project Manager(s): Planning staff (public art specialist) and Artist
- Selection Panel: the PPAC will act as the selection panel to rank qualified applicants and make final selection to award the contract to
- PPAC: approves final selection of Artist during RFQ and reviews final design against the project's goals and stakeholder/community feedback to ensure final design meets the identified goals of the Playground Project before their recommend for final approval by City Council to begin fabrication and installation of the design proposal. The PPAC's role will be limited after the awarded Artist is contracted to allow the Artist and Park Designer to work together within the scope, budget restrictions, and other considerations for each respective project.
- Other Committees and Commissions:
 - *Recreation, Music, and Parks Commission*: informs goals and design considerations for continuity and compatibility with Kenilworth Park renovations while reviewing the Playground Project through the Commission's purview. Recommended joint session with PPAC for recommendation of final design.
 - *Planning Commission*: informs Park Project (and possibly Playground Project) about criteria in planning criteria and in citywide context.
 - *City Council*: final approval body for Playground Project design and approval for Public Art Fund spending towards installation, fabrication, and construction towards the Playground project. Council will review the Playground Project proposal for approval in tandem with the Park Project's final design.
- Artist: creates the design proposal as described above in *Artist's Design Proposal*. Working in close collaboration with the contracted Park Designer, provides creative services as described above in *Role of the Contracted Artist* on the design proposal's concept,

engineering, fabrication, public hearing participation, final design, and execution of the Park and Playground Projects' construction at Kenilworth Park.

- City Staff: Artist will work with various City staff members and departments for review, planning, approvals, and construction of the Playground and Park projects. The following City entities and possibly additional not listed will be involved in the implementation of the Playground Project which the Artist/Design Team or Firm will be required to collaborate with during the Playground Project:
 - *Building Division*
 - *Parks and Recreation Department*
 - *Department of Public Works*
 - *Planning Division*
 - *City Manager's Office*
 - *Risk Management Division*
 - *City Attorney's Office*

Selection Process

- Community Engagement: City Communications and Marketing teams will design engagement opportunities for RMPC and PPAC staff liaisons to co-manage, including but not limited to surveys, table/booth events, public hearing public comment, social media, and other channels and events to facilitate public response. These responses will inform the development of the RFQ selection criteria and project goals.
- Request for Qualifications: The application process will be open for all eligible teams and individuals to submit their qualifications. The PPAC will review RFQ submissions to award a design contract for creative services between the Artist and the City in support of the Park Project.
- Playground Project Design Proposal: The Artist will begin designing the public art, play structure(s), and play spaces in close collaboration with the Park Designer to seamlessly integrate the design proposal into the proposed park site plan for consistency and appropriate context within the Kenilworth Park project site. Working with the contracted Park Project team, the Artist will use input from the community outreach and other staff and stakeholder comments to create a final design for the public art-playground structure design. The drafted design proposal created by the Artist will require continued review and modification throughout the project timeline until approved by City Council.
- Final Design: The Artist's design proposal will be reviewed by the PPAC before it is recommended for review and approval by City Council. The Park Designer's final design and the Artist's final design will be reviewed by Council in tandem. Included in the final design proposal for City Council's review will be the recommended Public Art Fund expenditure that PPAC will invest for fabrication, installation, and construction costs to create the proposal. City Council will review the public art expenditure for approval to

execute a contract for services by the Park Designer or a subcontracted playground builder.

- Fabrication, Installation, and Construction: The Artist will work with the Park Designer or subcontracted playground builder to complete all associated work to fabricate and install the playground artwork at the project site.
- Project Completion: Once construction and installation are complete, the new park, play features, and artwork shall be unveiled and have a celebration event, organized by the City.

Budget

The contract award for the Playground Project Artist is for a \$30,000 creative services contract with the City to fund the following services and cover the associated costs:

- Conceptual and structural design of the public art, play structures, and play features included in the design proposal
- Engineering of the space and all public art-playground structures, including any electrical elements if proposed
- Foundation and architectural design
- Research and incorporation of all play-safe standard equipment, materials, and surfaces used in the playground
- Travel stipend
- Consultation fees

Though not finalized, the anticipated commitment of Public Art Funds toward the installation, fabrication, and construction costs of the design proposal (outside of the Artist's contract award) is for an estimated \$150,000. These funds will be used for the following, including but not limited to materials, labor, play-safe surfacing, shipping, transportation, construction rentals and operations/logistics, site preparation, site improvements/clean-up, foundation construction, piers, footings, electrical, lighting, and other associated costs. Not included in this estimate is the project's contingency amount, which is \$30,000, which will be reserved for unanticipated costs or overages and shall be returned to the City's Public Art Fund if any amount is unspent.

Timeline

The following are the anticipated steps of the Playground Project's progress*:

- Community Engagement Survey (complete, March 2023)
- RFQ published (published May 1, 2023)
- Selection process and contract award (June 2023)

- Resolution for City Manager to execute contract between the City and Art for creative services and design proposal
- Artist begins consulting with Park Designer to create design proposal
- RMPC and PC study sessions with PPAC
- Artist refines design proposal in collaboration with Park Project contractor
- Review by PPAC before recommending approval to City Council
- City Council reviews final design proposal for Park Project and Playground Project and Resolution to approve final designs
- Fabrication of playground artwork
- Installation of playground artwork
- Unveiling/celebration event

**Note:* the City of Petaluma and Petaluma Public Art Program reserve the right to change, add, or remove the mentioned timeline above, followed by a notice to the public and to the involved parties. This timeline should only be used as a preliminary understanding of the project's process and is not intended for rigid application.

Park Project Schedule

The City intends to contract with the Park Designer in mid-spring 2023. The Park Designer shall begin the work as soon as the Professional Services Agreement for Design Services with the City is executed. The following is an estimated project schedule which is subject to change:

Milestone/Deliverable	Due Date
Project Kick-Off Meeting	May 2023
Preliminary Design Completion (30%)	August 2023
60% Design Completion	October 2023
90% Design Completion	December 2023
City Council Presentation	December 2023
100% Design and Bidding	January 2024

Application Requirements

The following materials are required by each applicant to be consider for this opportunity. Applicants must submit their materials by **Friday, June 9th 2023** to be eligible for consideration. All application materials will only be accepted digitally via SlideRoom using the following link to apply and submit: <https://petalumapublicart.slideroom.com/#/permalink/program/72201>. There is no application fee to apply or use the SlideRoom online application system. All required information and materials must be included or the application will be removed from consideration.

- **Completed Online Application.** This will include contact information, a current US address, and professional, work-related references related to similar projects or commissions.
- **Cover Letter (Letter of Intent).** Applicants shall describe in no more than three (3) standard 8.5"x11" 11-point font pages of a cover letter outlining your interest in this project and preliminary ideas for how you would approach this project. Cover letters shall respond to the indicated project goals (see *Selection Criteria and Project Goals* above) to demonstrate your understanding of the project objectives and include a high-level description of how each goal would be achieved. Applicants should also highlight relevant, related experience that supports desired qualities for completing this project as well as abilities to meet all project goals and eligibility factors listed.
- **Current Resume or CV.** Please include all relevant experience to designing artwork for outdoor public settings, museum exhibition spaces, play structures or spaces, and other adjacent projects that display qualified experience. If applying as a team or firm, please identify a project leader and primary contact as well as a link to other team members' resumes or CV's that will be involved in the project.
- **Annotated Image List.** This will include other projects or commissions that you (and/or your team) were involved in or produced. The image list should include between five (5) and ten (10) samples of work including the work title, date/date of completion, materials, dimensions, location, a brief description of the project, and the art project/commission budget for each work.

Appendix A - Community Engagement Survey Feedback

Between January and March of 2023, the Public Art Committee and Program launched a community engagement survey to gather feedback to inform the Playground Project's goals and priorities. This survey, which was offered both digitally and in-person as well as in both English and Spanish, received 173 responses. The following section displays all the data collected from the community survey. The collected data was used by staff and the Public Art Committee to generate goals used in this RFQ document for applicants to respond to in addition to selection criteria. Survey respondents were asked six (6) questions on the topic of public art and the Kenilworth Playground public art project with intent to inform the RFQ goals and selection criteria for this opportunity. All questions were required responses in order to submit the completed survey, with exception to the last question (survey question #6) which was optional.

Survey Question #1

What do you think the role of public art should be in a playground or park? (Please select your top choice from below)

173 responses



The top answers were as follows:

1. Be whimsical and inspire creativity (31.2%)
2. Make a welcoming and inclusive space (30.6%)
3. Support learning and fun (20.8%)
4. Invite diversity and new ideas into our community (6.4%)
5. Celebrate our community's history, identity, or heritage (4.6%)
6. Look forward to our community's dreams and future (1.7%)

"Other" responses included (in no particular order):

- "I would love to see a nature mural/art piece at this park"
- "Be family focused and able to incorporated into play and exploration"
- "To be beautiful, reflect the culture, inspire the community's highest ideals"
- "Be functional, such as a fountain that kids could play in"
- "Be interactive and sturdy enough to climb as part of a play structure"
- "All of these"
- "Fun to play at"

Survey Question #2

What playground features would enhance your experience at Kenilworth? (Please select your top 3 options)

173 responses

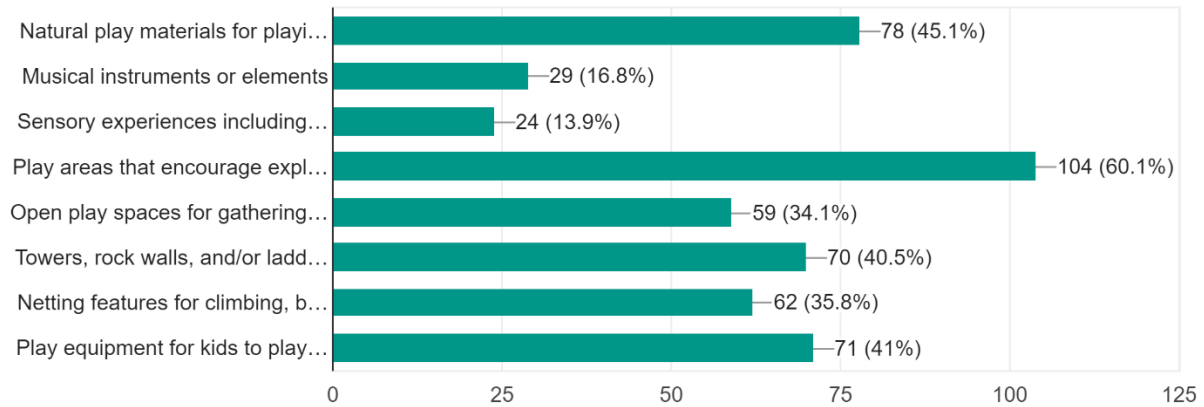

The features ranked by respondents were as follows (respondents chose three features):

1. Play areas that encourage exploration and discovery (60.1%)
2. Natural play materials for playing and exploring (45.1%)
3. Play equipment for kids to play along with adults (41%)
4. Towers, rock walls, and/or ladders for climbing (40.5%)
5. Netting features for climbing, balance, and fitness (35.8%)
6. Open play spaces for gathering and social play (34.1%)
7. Musical instruments or elements (16.8%)
8. Sensory experiences including touch, feel, smell, and listening (13.9%)

Survey Question #3

Which of the following themes do you think a playground should emphasize to youth? (Please select your top 3 choices)

173 responses

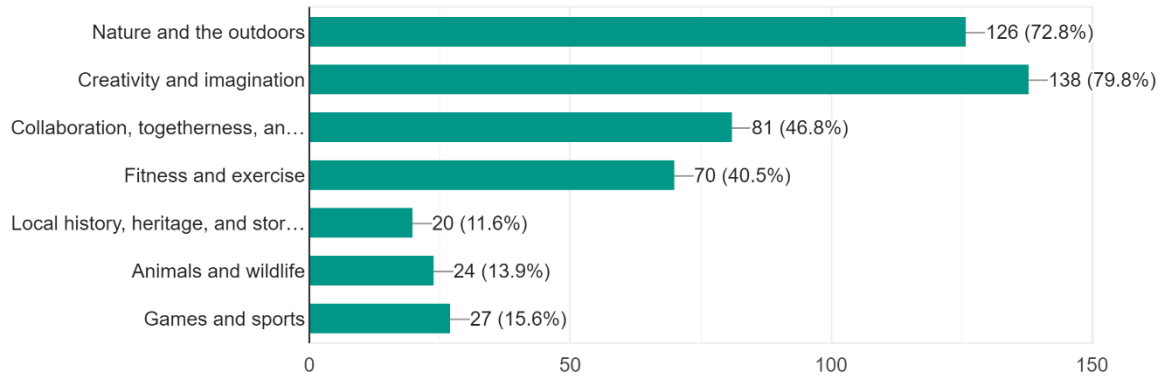

The themes ranked by respondents were as follows (respondents chose three themes):

1. Creativity and imagination (79.8%)
2. Nature and the outdoors (72.8%)
3. Collaboration, togetherness, and teamwork (46.8%)
4. Fitness and exercise (40.5%)
5. Games and sports (15.6%)
6. Animals and wildlife (13.9%)
7. Local history, heritage, and stories (11.6%)

Survey Question #4

What opportunities would you like Kenilworth Park playground to offer youth? (Please select your top 3 choices)

173 responses

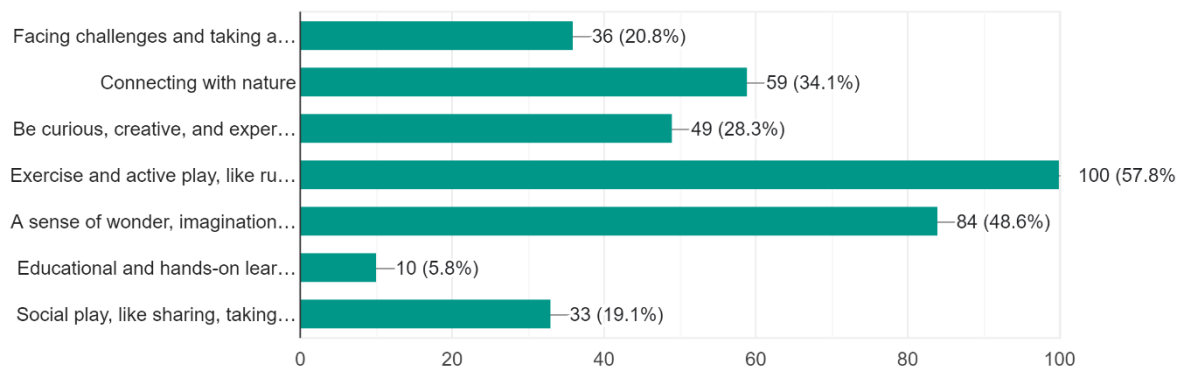

The opportunities ranked by respondents were as follows (respondents chose three opportunities):

1. Exercise and active play, like running, jumping, climbing, and swinging (57.8%)
2. A sense of wonder, imagination, and adventure (48.6%)
3. Connecting with nature (34.1%)
4. Be curious, creative, and experiment with new materials (28.3%)
5. Facing challenges and taking appropriate risks (20.8%)
6. Social play, like sharing, taking turns, playing sports/games, and cooperation (19.1%)
7. Educational and hands-on learning (5.8%)

Survey Question #5

What is the best way to make a playground inviting to everyone? (Please select your top priority choice)

173 responses

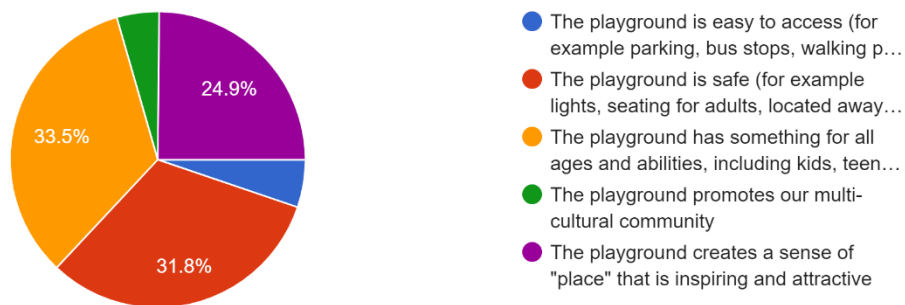

The top responses ranked by respondents were as follows:

1. The playground has something for all ages and abilities, including kids, teens, and families (33.5%)
2. The playground is safe (for example, lights, seating for adults, located away from busy streets) (31.8%)
3. The playground creates a sense of "place" that is inspiring and attractive (24.9%)
4. The playground is easy to access (for example parking, bus stops, walking paths, bike racks) (5.2%)
5. The playground promotes our multi-cultural community (4.6%)

Survey Question #6

What else can the playground offer to make the space more welcoming, safe, and attractive to our community? (For example shade structures, bike racks, swings, flexible spaces for gathering and events) (optional)

The following displays the 126 responses from this optional question:

Shade and visual and noise barriers to the busy Payran and E Washington Streets. Kids could easily wander or run into the street if parents are watching like hawks. Outdoor gathering space for library events would be great. A safe place for teens to hang out in the evenings would be splendid. The neighborhood needs this.
Shade
Lights
Flexible gathering spaces, crosswalks added from East D to Payran at the stop sign space
Regular maintenance and bring back the volleyball space.
All of the above (shade, bike racks, SWINGS, flexible spaces) everything mentioned throughout this survey!
Care for the trees to maintain shade and open space for catch, frisbee, picnics minus gophers!
Shade, accessibility
Petaluma desperately needs more Open Spaces within the city. There has been too much over-development with every empty block and no consideration for cross town congestion, or parking or walk ways and the need for these open spaces. For a healthier community this has to be taken into consideration. It is sad to destroy a community like this, just for Development's sake and profits.
open space with seating
More picnic tables and bike racks
Bike racks
Picnic tables and benches or places to sit
Tables benches
Safety fencing, rubbish bins, ample seating for families, lighting, bike racks, shade , picnic area
For question 4, it asked for 3 choices, but didn't let us select more than one. Our other choices are: "Be curious, creative, and experiment with new materials" and "A sense of wonder, imagination, and adventure"
Unfortunately our poor homeless folks look for rest there and that deters youth from playing and parents too
Plant fruit trees and colorful flowers around the perimeter.
shade structures
Fewer gopher holes, better drainage, less garbage, reduced homeless population/useage
Slides, picnic tables, benches, shaded areas
Shade structures, bike racks, benches and picnic tables, restrooms, water features to play with, protection from main streets, welcoming community programming
Blocking the view of Washington street would make the park feel safer. Also shaded picnic areas away from the playground would be nice for picnics (for people with or without children)
Shade structures, flexible spaces for gathering, a giant swing that adults can fit in with their kids
Shade structures and picnic/activity tables and benches
Shade, easy access, clean
Colorful and inviting. It should help add to the place making of the park. I would like it to be interactive and highly imaginative.

Restrooms
Bike parking
All of the above. #1 safety, #2 accessibility (parking etc), #3 inviting (attractive)
Designing a play space modeling the Petaluma river would be creative! Maybe a pretend dry River with stationary canoes, tugboats, etc? Maybe the Petaluma Museum could add some signage with stories about the river/slough? It's such an important part of the city history! Also, our summers have been getting so hot. If there was a way to have water play or a splash pad or something similar (with water set up to be recycled and reused), this would be a great (free) space for kids to be able to cool off.
we need a bike park, builds community because all users need to share space, encourages challenges and develops skills
SHADE over tables & seating, must be beautiful, designed to encourage people to relax and feel an oasis during the summer or when wet. Outdoor space is valuable community gathering space, make it comfortable. Playground must be interesting and state of art. See Glen Park in San Francisco for a good example. There are 2 problems with your form: "what opportunities" question only lets me choose 1 answer. "what themes" question is vague: is this an art theme or the physical structure of it?
Creative sitting areas for adults and others too tired to play!
Shade structures, all ages equipment, swings
Shade structure is huge. Would love ART, a sustainable water feature and a big rock climbing wall. Very concerned about safety given unhoused population that tends to congregate there
This park gets HOT, so yes, shade structures, benches, picnic tables, how about a splash pad? Attractive fencing along the busy street. more plants, more garbage cans. This park is always so dirty, I stopped taking my kids there.
Trees, shade, clesn
Shade structures are necessary in the summer or the park is inaccessible. Its only going to get hotter with
Shade trees. Adult seating nearby so adults can keep an eye on kids but without being in the way of their play.
Please keep the big tree that is left. Please have swings that are for everyone and not just toddlers/babies.
Please keep the mature shade trees! Tire swings - we don't have any left in public Petaluma park. Swing benches or swings for multiple riders would be fun too.
Visual (art/murals) features that represent all of Petaluma especially race/ethnicity and ability.
All of the above, and bathrooms if there arent any
Shade and bike racks for sure. Picnic tables, water bottle filling station, and designated garbage area.
Yes to shade structures, bike racks, covered picnic tables. Would love to see mosaic work. i wasn't able to select top 3 2 questions above. the other 2 would be: a sense of wonder imagination adventure, exercise & active play
Truly accessible equipment and park structures. Handicap and all abilities.
Wind block, shade structure
Swings
Historically this has been a hang out spot for homeless and sometimes doesn't feel safe or clean. Not sure how to speak to that, but creating a safe and clean area is important
swings for all ages; shade to encourage year round use; bikes for security; seating for all to sit, gather and engage

Picnic tables and seating areas. Swings! Kenilworth has no swings currently! Non static playgrounds (playgrounds that kids can manipulate and move- see Berkeleys Adventure Playground!)
Shade structures make the playground useable during the day in the summer when it would be too hot to touch otherwise.
Would love a park like Seven Seas Park in Sunnyvale water spray pool, soft landing, baby area gates off, big kid area, one of the best parks.
fencing for younger kids because it's on a busy street. a place for kids from McKinley to gather and sit outside with one another to do homework or hang out after school
Shade structures and benches or seats for elders and differently abled people.
Trees! Multi age spaces for toddlers to seniors
picnic tables for adults to gather and eat together, including some with shade structure for the summer months as well; slow streets around the park; stop signs/crosswalks
A water feature for hot days, that kids are allowed to play in. Wading pond or fountain.
Swings, slides, interactive art
Walls/fences blocking the main roadway. Trees and shade. Better parking/signage. Night time security. Cleaning and upkeep.
Shade, swings, mazes, climbing, pushable merry-go-round
Trees, shade structures as well as games/structures that promote our multi-cultural community.
Tables, seating
Swings, area with benches and tables
No dogs allowed
Trees! I was disappointed to see the main shade tree over the playground chopped down this weekend. I'd rather have trees than shade structures, but now a shade structure will be necessary. Monkey bars and swings are a must. A pavilion would also be great for parties. We don't have that kind of space here in midtown.
Accessibility for all disabilities, teens, seniors, ...
Shade structures
Shaded area
Seating near the playground, keeping it clean and maintained
Fencing that provides some containment for toddlers and young ones away from the road, big trees for shade, lots of plants, a sand area for playing in, benches for parents to sit nearby, a playground designed for toddlers
The best way to make this playground more appealing is to make it safe and clean for children in the neighborhood (and students at McKinley & Live Oak who usually pass by but rarely stop), despite its location in the middle of town which sometimes attracts the unhoused & the addicted.
Swings, Shade, regular cleaning and security checks. Lots of random lurkers in that area. Why are you there watching kids play?
Shade, bike racks, benches, keep it clean
Maintenance. Too often playgrounds will have trash (or worse, cigarette butts and drug paraphernalia). If you build it, it should be maintained daily.
Things for kids to do alone as well as with others

Most parks emphasize young kids. Focus on teens, who lack services relative to other kids. For example, skateboarding/skate park & bmx. Athletic activities that don't require being an organized sport or a team to include more kids.
Wide variety of puzzles and personal exercise pieces like jump rope,
Shade is huge and places for gathering.
It's pretty simple, covered and uncovered space with seating for people to gather for multipurpose. The park currently has too much area with grass and is mostly inviting to dogs. Sure, leave part of grass for dogs to play but more areas for humans of all ages to comfortably sit and be social. not just playground.
Shade! And local art!
Regular cleaning, tables
Shade and swings, definitely!
Seating in shaded areas
The things listed, plus benches and tables for parents,
Safety via inclusivity is a priority. Celebrate and emphasize diversity. Minorities, disability community, teen & young adults all lack services relative to others.
Benches closer to the actual playing structure, shade structure and keeping it clean.
Art sculptures, Lights, benches, shade, garbage bins that get emptied often not weekly.
Shade structures, seating, more trees, plants
A splash pad or water feature of some kind would be amazing.
Shade structures, swings and a seesaw
Something that this town truly, TRULY needs in order to support new parents and young families is a fully fenced and gated playspace. I recall when my son was a toddler I was so deeply exhausted. All I wanted was a space where I could sit and watch him safely explore for a moment and not have to worry about him exiting the play area. I had experienced the magic of a beautifully fenced play area at park in the Menlo Park and Sacramento areas and it was brilliant and so needed that I wept with joy (and tiredness). Additionally, Kenilworth needs several banks of BigBelly trash, recycle, and compost receptacles and not just rolling trash cans. The rolling cans are really unsightly and not conducive to supporting visitors to properly dispose of litter and waste.
Shade. Trees.
shade structures, bathrooms, water station (bottle refill or water fountain)
Shade structures are lacking at most parks here, fun and creatively designed structures that attract the visitors to the library to continue reading outdoors! Materials that will stay safe and not easily broken. Well lit and drained.
Community events near or at the park
Shade structures and picnic tables
Petaluma is largely absent of an exciting playground, heavily themed with tall slides. ...especially on this side of town. It would make a lot of sense to connect this space with the library.
Shade
Shade areas and tables or seating areas to eat snacks

Fully accessible playground for ALL kids. (Lucchesi shouldn't be the only playground that offers equipment for kids with disabilities.) Let's make our whole community accessible. All kids matter.
Swings for all ages and abilities; interactive art displays; bike rack
Handicap accessible. Shade structures
I love the padded (rubber?) ground covering that some parks and schools use. Kids can run and fall or fall from climbing structures with little to no injury.
Shade
Shade and bike racks
Shade would be wonderful. Also not necessarily a fence, but some sort of barrier around the playground as the streets around the park are busy. Might help give parents of young kids some peace of mind.
Community garden plots, fencing for safety
art and creative sculpture
Shade, an area for eating, and keeping dogs and people from setting up encampments there
Somewhere it's ok to skateboard at, a curb or planter designed just for them to be welcomed is smart, also wood and metal playgrounds I've enjoyed as a kid, and bringing my son to
Shade, picnic tables, bike accessible, dog friendly
Shade structure, a feeling of division or privacy from the street. And a place to ride and scoot scooters around the park. Like Walnut Park has.
Shade structures is a huge one, many parks do not have them and during the summer a lot of the playground is too hot to play on
Shade, bike area, picnic area, cozy seating areas
Shade trees, bike and scooter parking, resting places, gathering spaces
Shade!
a fun place for everyone!!!
Shade structures (or better yet, trees!) are important! Accessibility is another important part; for a community wide project, The park needs to be easily accessed by parents with strollers and baby gear.
Shade structure, water feature
Uniqueness. Something that sets it apart from other playgrounds. Make it a destination.
Shade structures and seating area
Bike racks, shade structures seem critical in our super hot summer months!
My grandchildren were heartbroken when the city removed the lovely trees around the park, and robbed the park of its nicest amenity--shade on warm days. I have never received an explanation as to the City's reasons for virtually clear-cutting the park. Many of us believe tree replacement to be essential, and urge the City to set up LOTS of other shade structures to compensate for its sad decision to remove the trees. As the park is near a busy street, some fencing would be helpful. Also, it would be helpful to have an artful path for travel back and forth to the library.
Shade, clean, safe, unique.
More seating for adults

Appendix B – Inspirational Project Design Examples

The following projects are examples that inspired the PPAC and the concept of this opportunity. The City of Petaluma, PPAC, and Petaluma Public Art Program are in no way affiliated with the following projects and are included in this document for the sole purpose of providing applicants to this opportunity with examples of projects that supported the vision, outline, and design of this project.

Inspiration Work #1 - “La Brea Park Playground”



Image source: <https://www.lobykin.com/la-brea-playground>

Credit to: Oleg Lobynkin, Projects Pacific Inc., and Park La Brea Apartments, Los Angeles

Inspiration Work #2: “Big Girl Playground” or “Playground (Silver Towers Playground)”



Source: <http://www.tomotterness.net/artworks/big-girl-playground>

Credit: Tom Otterness, Westchester's Ride Hill, and Silver Towers

Inspiration Work #3: "Howling Coyote"



Source: <https://www.earthscapeplay.com/project/sir-wilfrid-laurier-park-edmonton-coyote-playground/sir-wilfrid-laurier-park-custom-wood-natural-playground-howling-coyote-sculpture/>

Credit: Earthscape, City of Edmonton, Wilco Northwest, and Sir Wilfrid Laurier Park

Inspiration Work #4: "Vail Nests" or "Sun Bird"



Source: <https://tresbirds.com/VAIL-NESTS>

Credit: Tres Birds, Architecture + General Contracting, and Town of Vail (CO)